

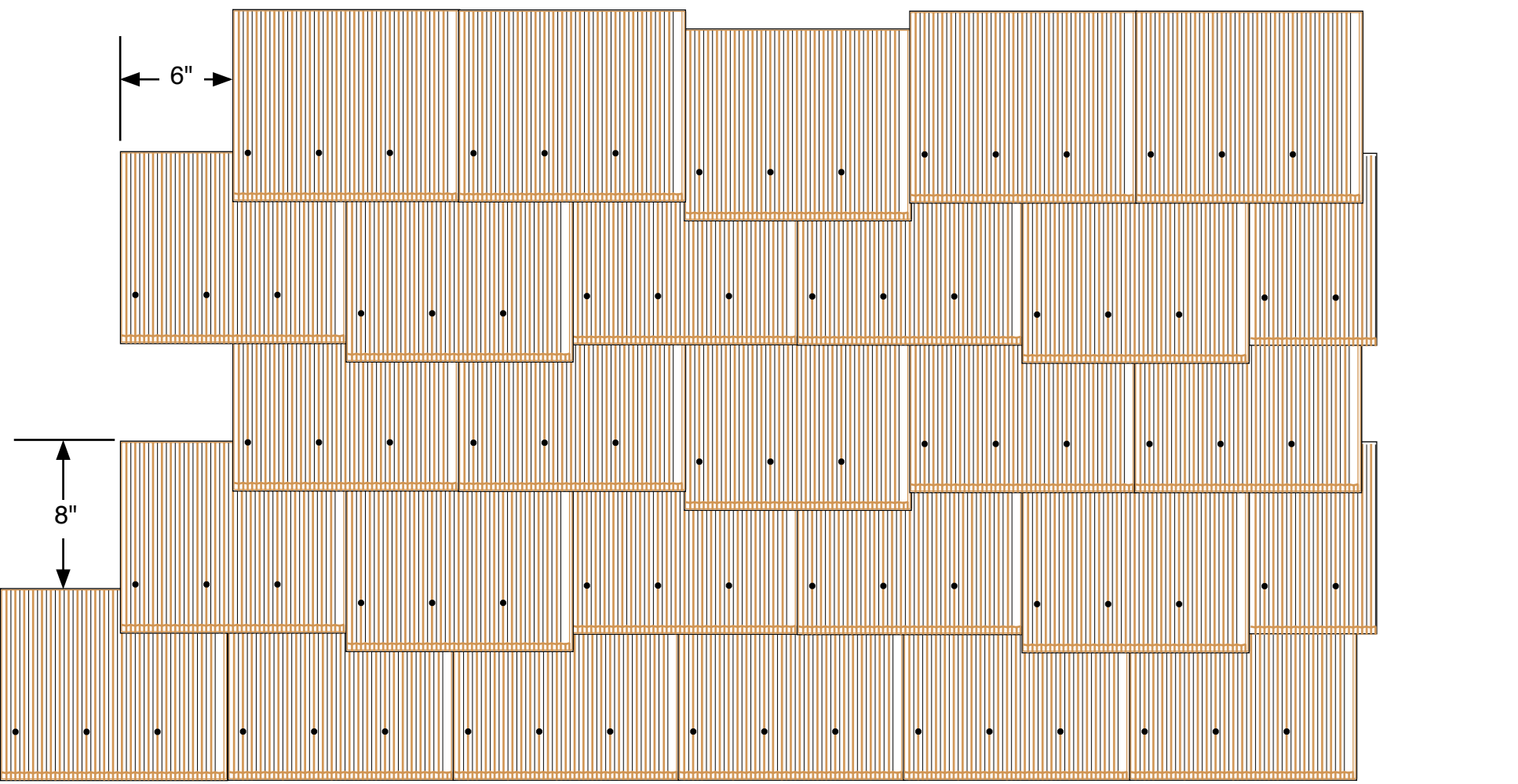

Drop Pattern

with Standard Reinke Shakes

This is the same as the Classic Pattern, except that every 3rd. shingle is dropped 1".



Connecticut Pattern with Standard Reinke Shakes

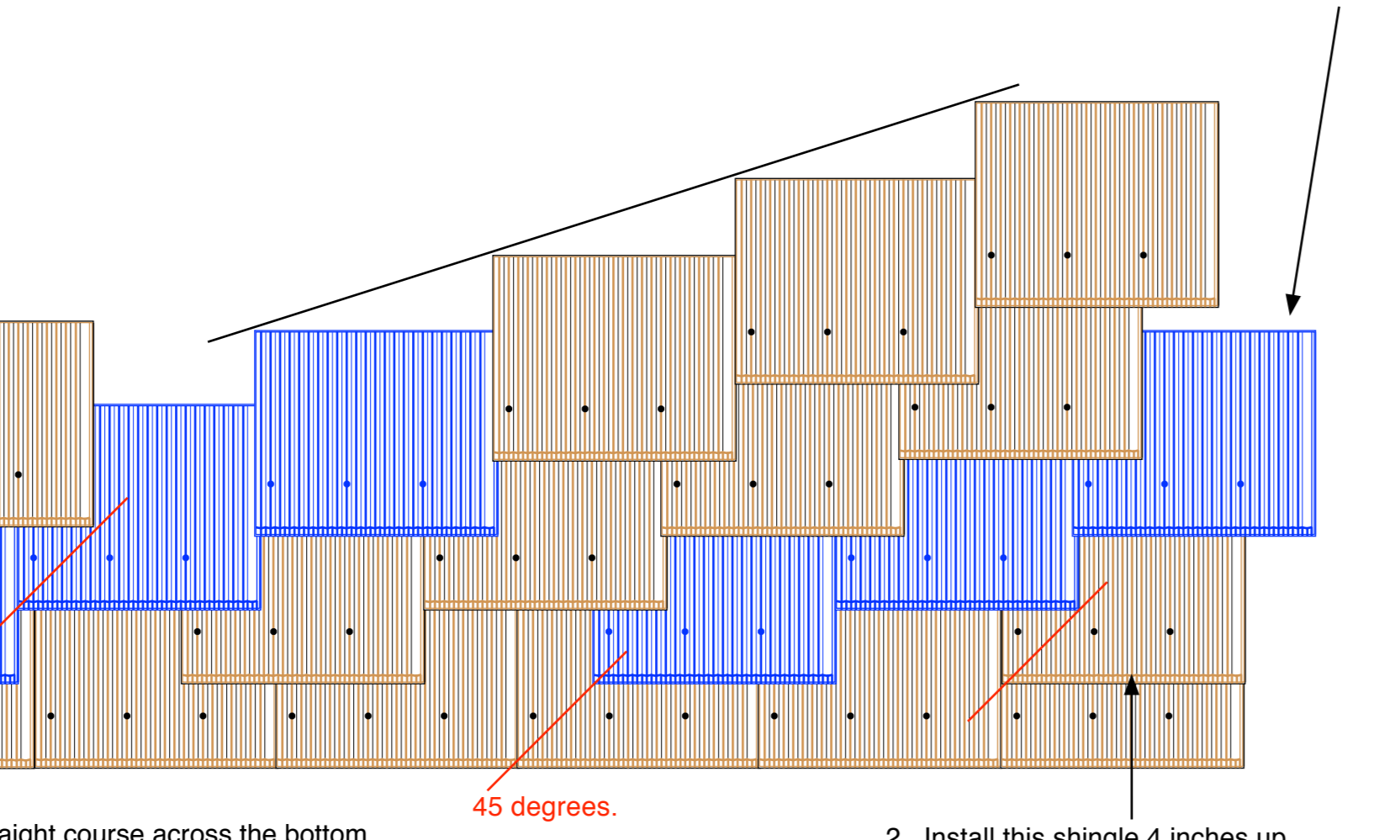

1. Install one straight course across the bottom.
2. Install this shingle 4 inches up.

3. Install these 3 shingles. Left bottom corner is 4 inches up and 4 inches to the right. Each shingle to the right is 4 more inches higher up.



Classic Pattern with Standard Reinke Shakes

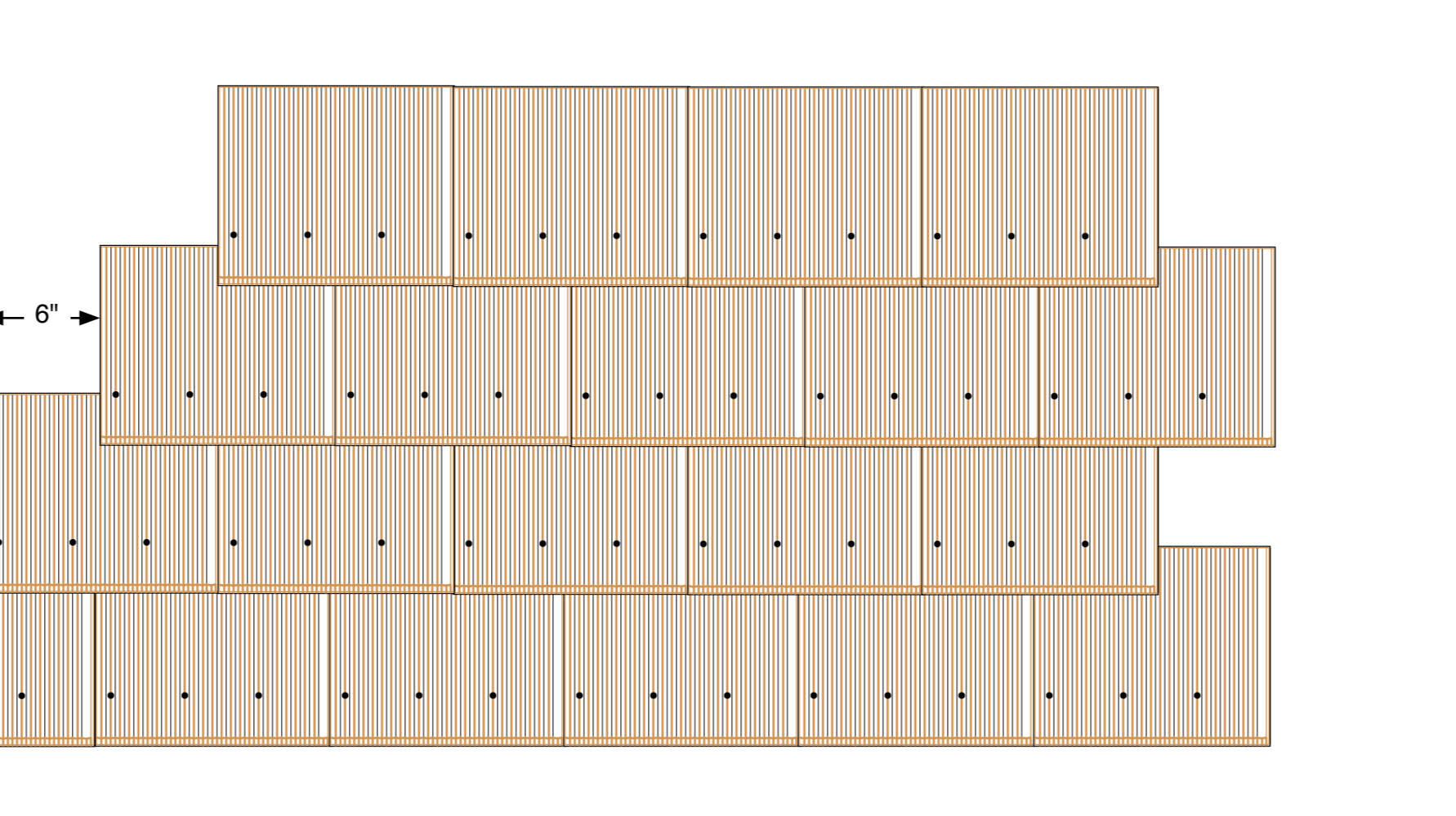

Vertical Stack Pattern with Standard Reinke Shakes

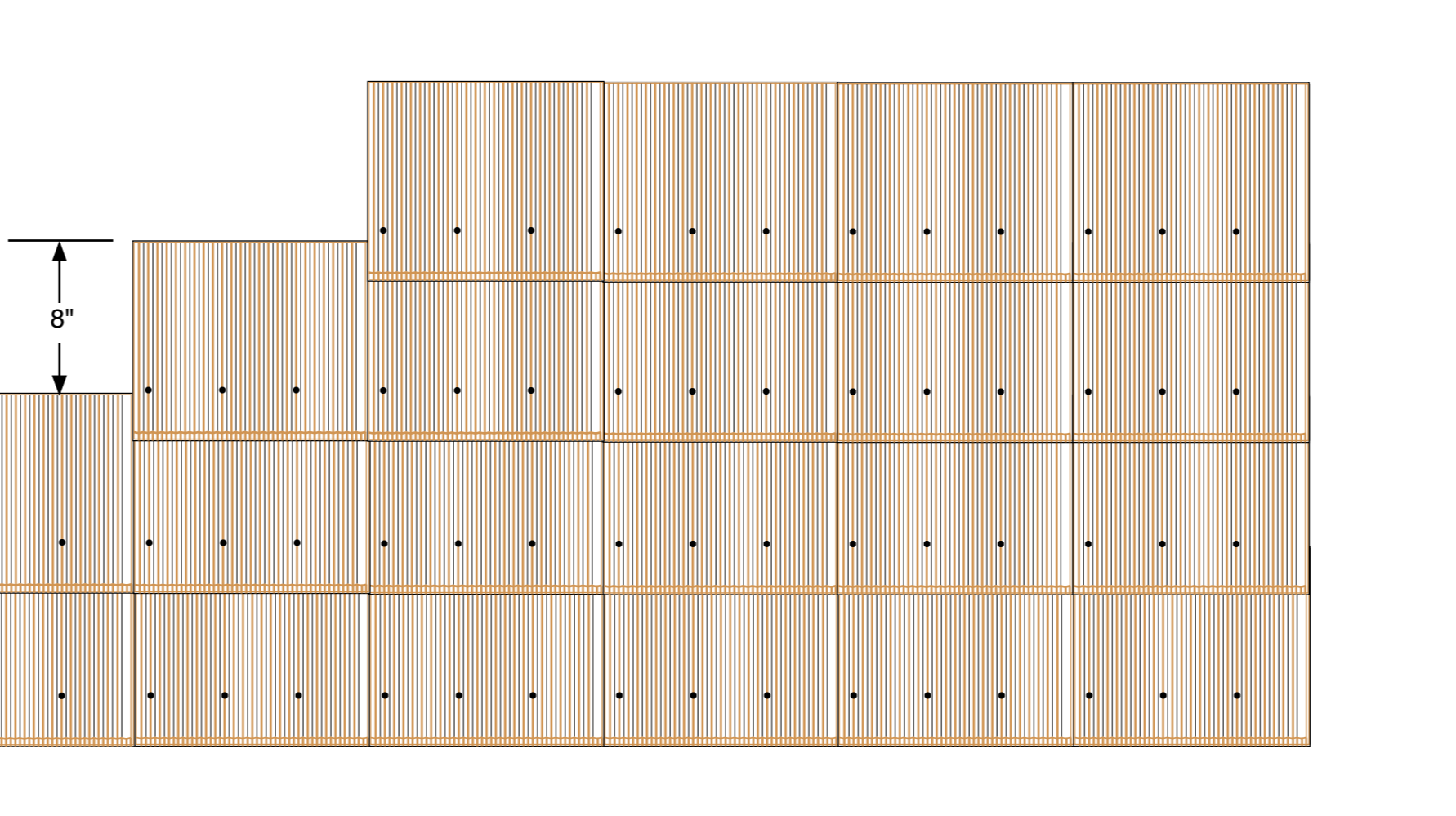

Vertical Offset Pattern with Standard Reinke Shakes

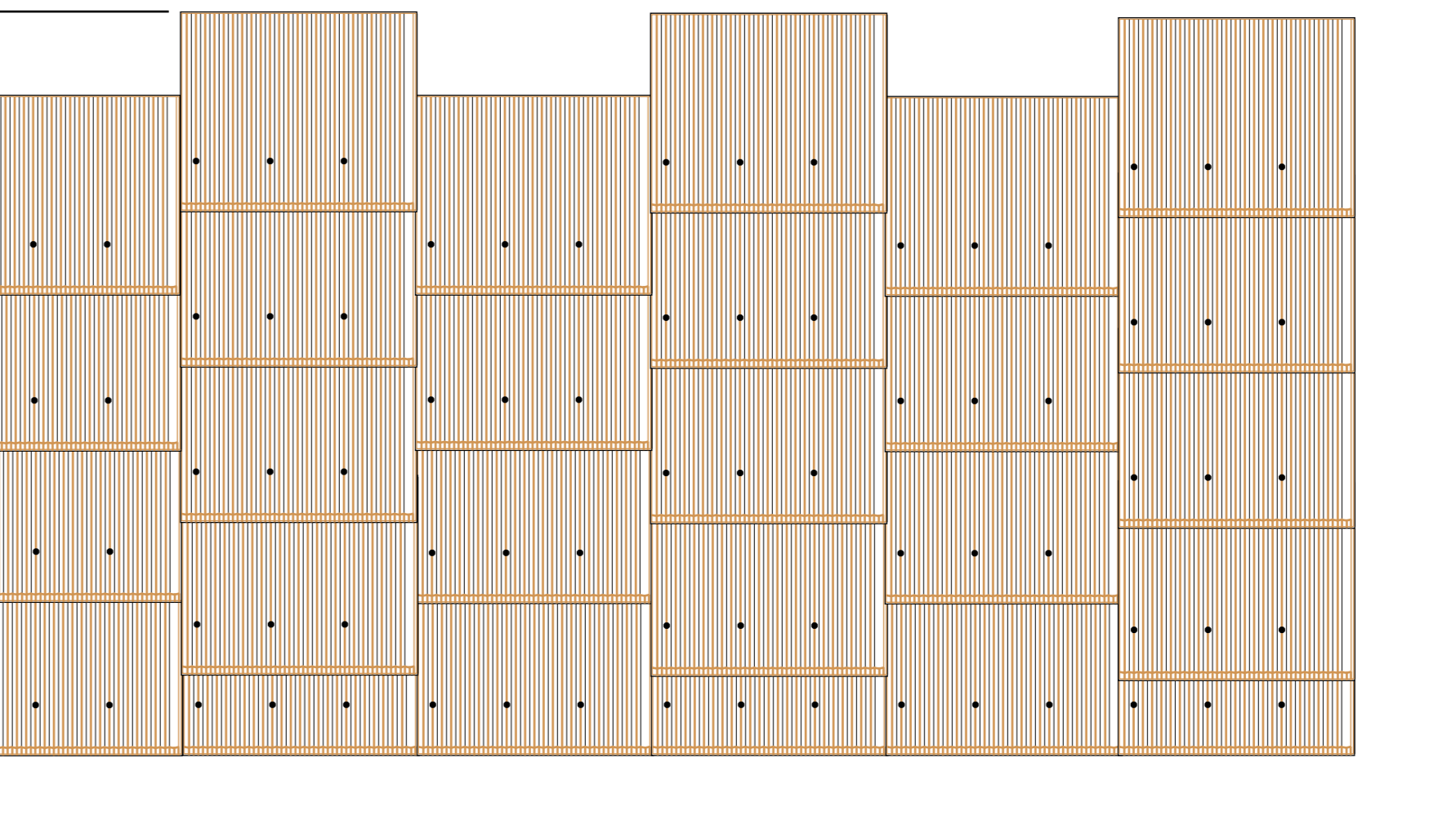

Double Row Classic Pattern with Standard Reinke Shakes

